

**AEP Exclusion List-Phone #.xls**

Preview Refresh

G:\Credit Department\1 DCO Structure\Predictive Analytics - DCO\SPSS Models\AEP Exclusion ...

Data Filter Types Annotations

File type: Excel 97-2003 (\*.xls)

Import file: G:\Credit Department\1 DCO Structure\Predictive Analytics - DCO\SPS...

Use named range

Choose worksheet:  By index 0  By name

Range on worksheet:  Range starts on first non-blank row  Explicit range of cells

On blank rows: Stop reading

First row has column names

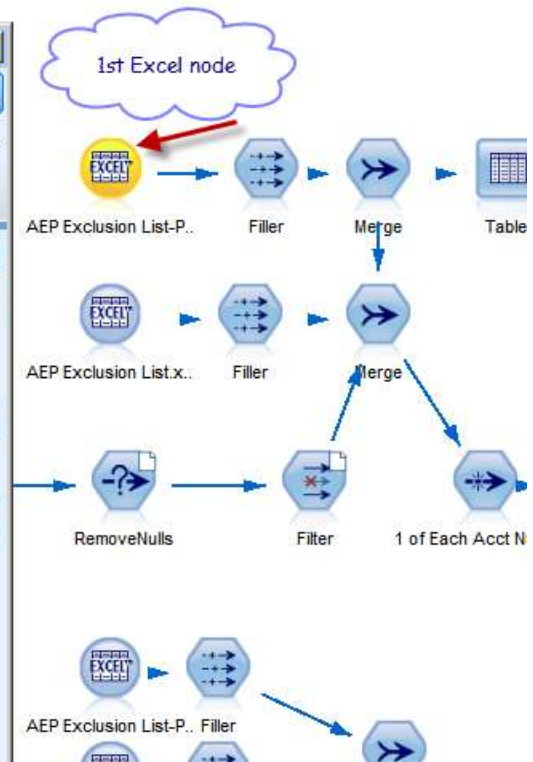

**Filler**

Preview

Settings Annotations

Fill in fields:

Exclude1

Replace: Always

Condition:

```
1 @BLANK(@FIELD)
```

Replace with:

```
1 substring(1,10,to_string(Exclude1))
```

OK Cancel Apply Reset

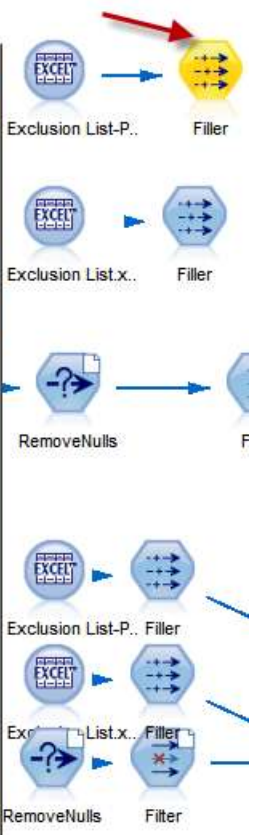

Merge

Preview

Merge 1 dataset. Merge method: Condition

Inputs Merge Filter Optimization Annotations

Merge Method: Condition

Add tags to duplicate field names to avoid merge conflicts

Condition:

```
1 Phone1=Exclude1
```

Include only matching records (inner join)

Include matching and non-matching records (full outer join)

Include matching and selected non-matching records (partial outer join)

Select...

Include records in first dataset not matching any others (anti-join)

Merge

Merge

Merge

Merge

Merge

Merge

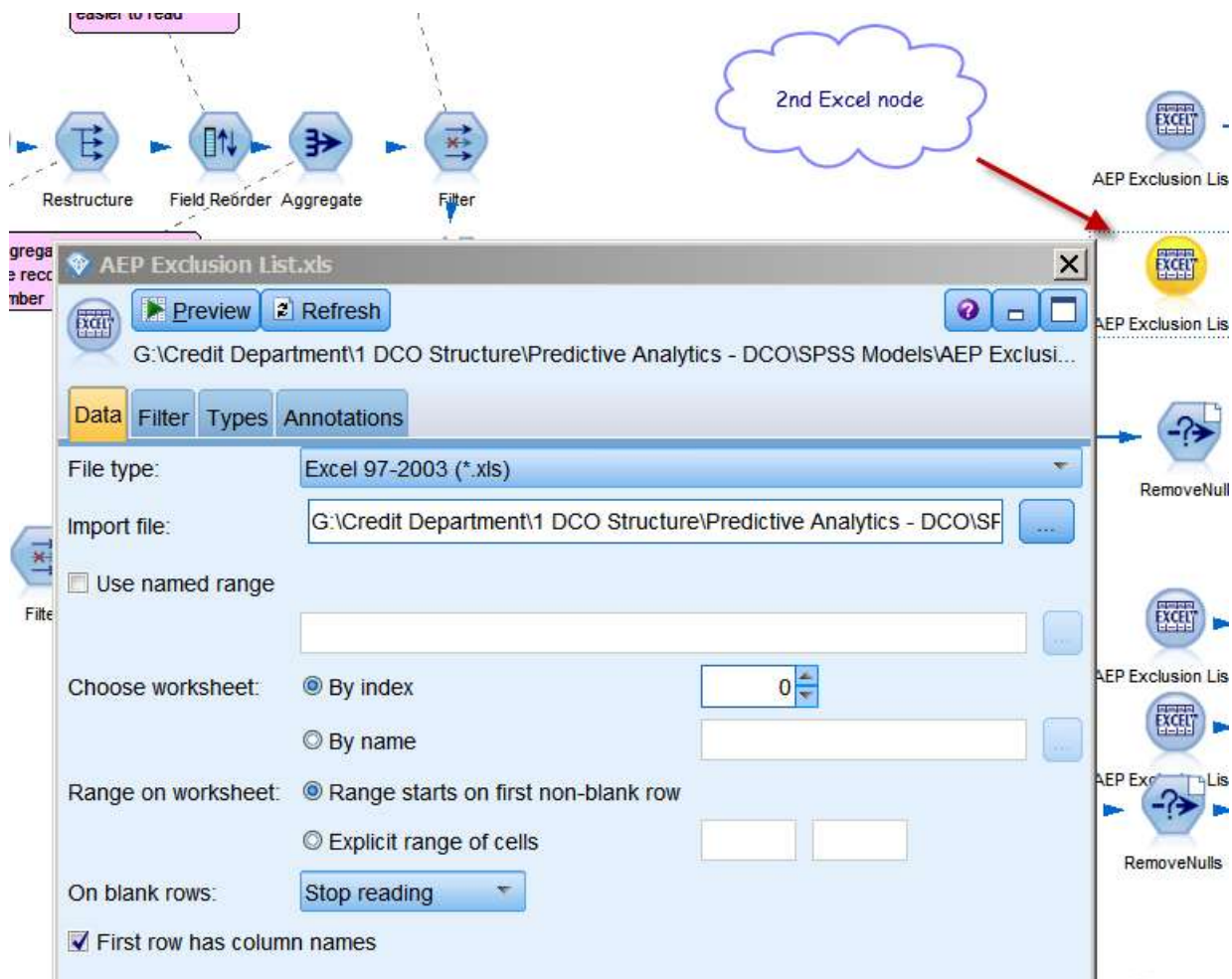

**Filler** [X]

Preview

Settings Annotations

Fill in fields:

Exclude

Replace: Always

Condition:

```
1 @BLANK(@FIELD)
```

Replace with:

```
1 substring(1,14,to_string(Exclude))
```

OK Cancel Apply Reset

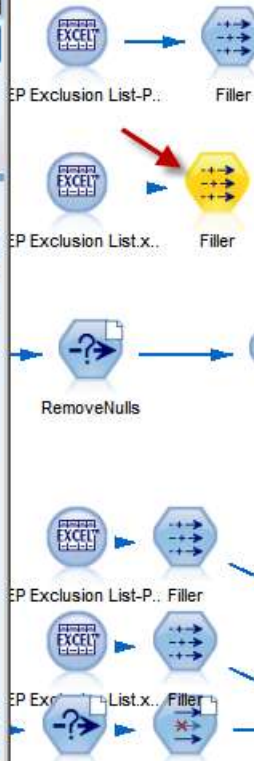



1. Pick up the new names

### Merge

Merge 3 datasets. Merge method: Condition

Inputs Merge Filter Optimization Annotations

Merge Method: Condition

Add tags to duplicate field names to avoid merge conflicts

Condition:

```
1 AcctNumber=Exclude
```

Include only matching records (inner join)  
 Include matching and non-matching records (full outer join)  
 Include matching and selected non-matching records (partial outer join)  
 Include records in first dataset not matching any others (anti-join)

OK Cancel Apply Reset

